



PT44HSRICKL+10

FEATURES:

- 304 Stainless Steel Welded and Polished Top Assembly, Apron, Ends, and Splash
- Includes 3 Piece Sliding Cover
- 11" Deep Ice Bin
- Cold Plate Units have 15" Front Apron and Sides
- 44" and 72" Combo Units Include Dual Handsink with Low Lead Compliant Faucets
- 6" Splash Guard Between Sink and Ice Bin
- 8 Circuit Cold Plate (+8)
- Constructed to Meet NSF Specifications
- Optional: Blender Shelf, Speedrails, Skirting to Hide Leg Assembly, and/or Upgrade from an 8 Circuit Cold Plate (+8) to a 10 Circuit Cold Plate (+10) for Minimal Upcharge, 1/2" Female Pipe Thread Drain

MODEL NUMBERS:

Description	Model
Pass Thru Bin	PT36
	PT36+8
Combo Pass Thru	PT44HSRICKL+8
	PT72HSRICKL+8
Cold Plate	10 Circuit Cold Plate

PASS THRU

SIDE VIEW:

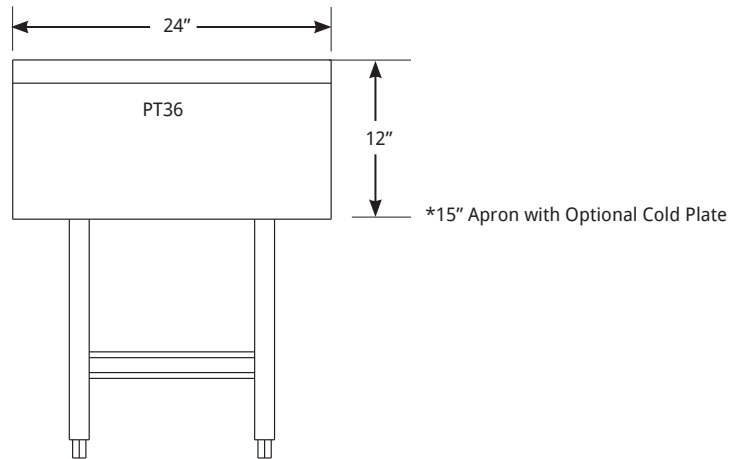

TOP VIEW:

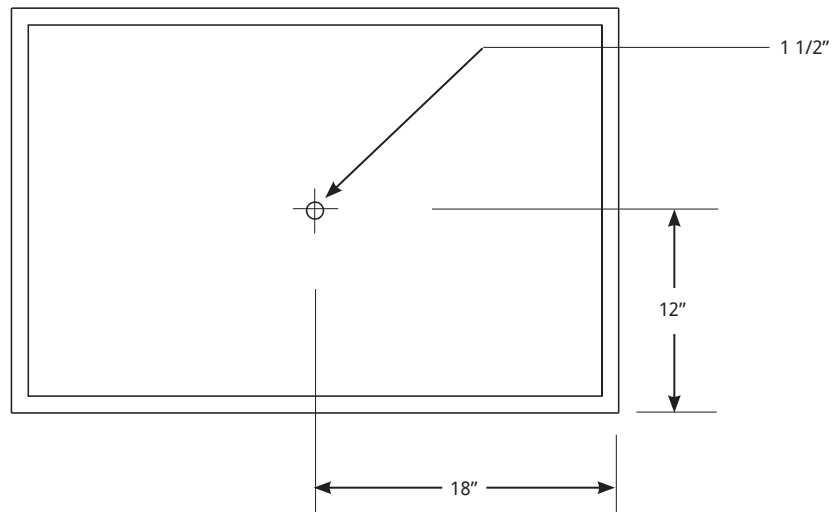

FRONT VIEW:

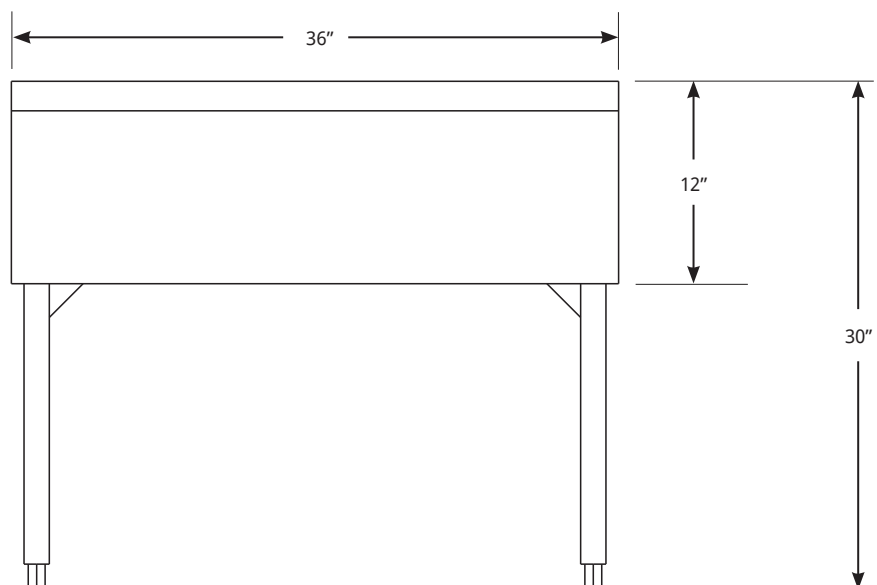

PASS THRU

SIDE VIEW:

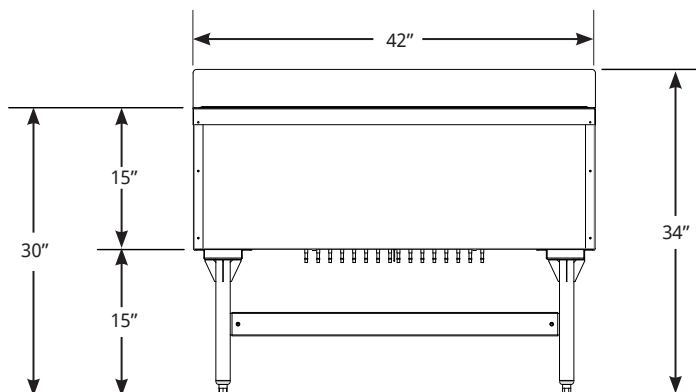

TOP VIEW:

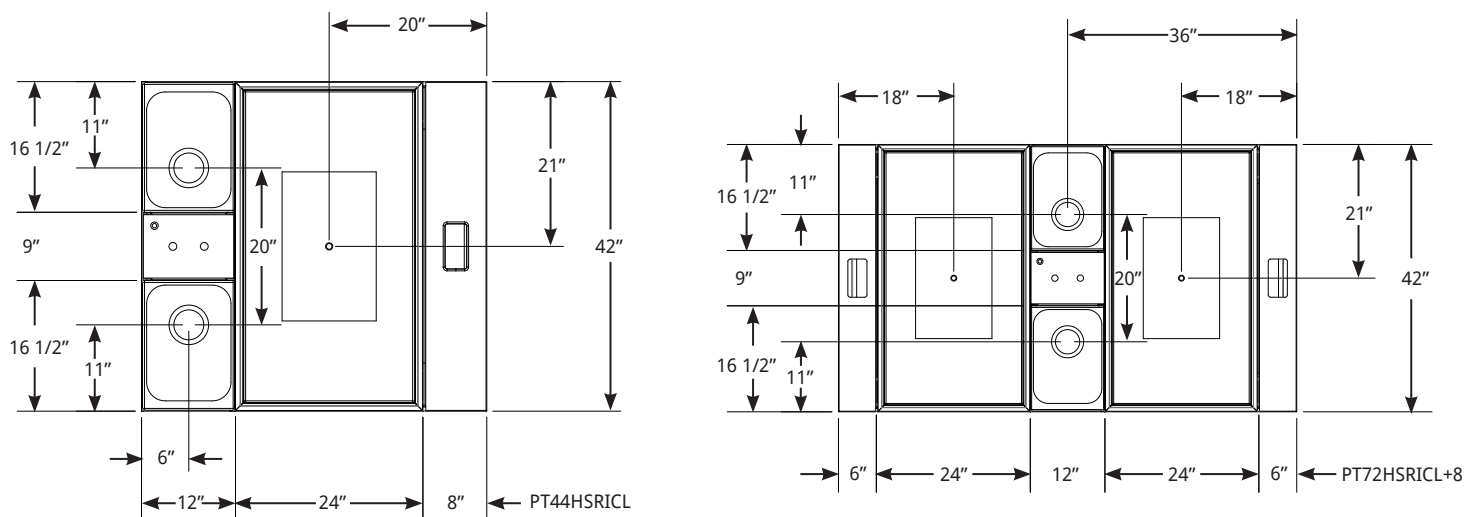

FRONT VIEW:

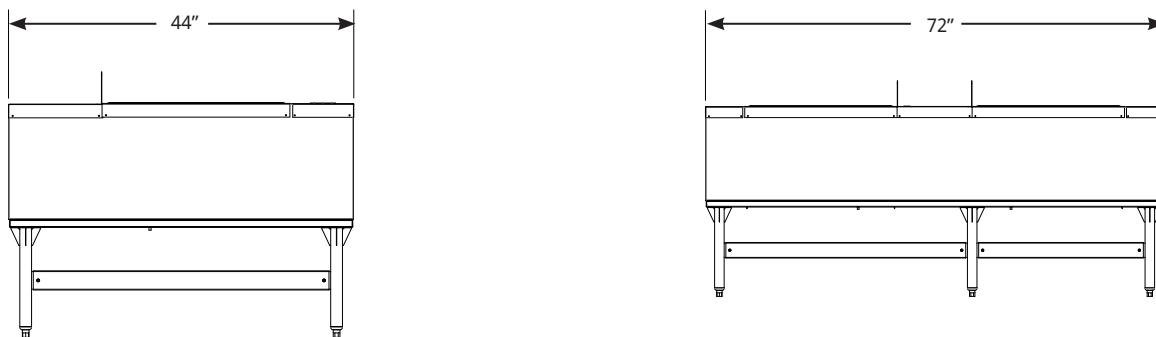

LaCrosse has a policy of continuous product improvement, and reserves the right to change design and specifications without notice.

L#1011.0317